

Liquent InSight 6.2 CHF 5 Upgrade Guidelines

Table of Contents

| | |
|----------------------------------------------------|----|
| Liquent InSight 6.2 CHF 5 Upgrade Guidelines..... | 1 |
| Migration Path..... | 4 |
| Post-Installation Tasks..... | 6 |
| Create Assembly Templates from Template Files..... | 8 |
| DTD Files..... | 9 |
| eCTD Template Files..... | 12 |
| Liquent InSight 6.2 CHF 5 IQ Scripts..... | 19 |
| Index..... | 20 |

Liquent InSight 6.2 CHF 5 Upgrade Guidelines

These upgrade guidelines are current as of 03-AUG-2020, and can be used as a reference to upgrade your Liquent InSight from version 6.2 CHF 4 to version 6.2 CHF 5, along with supporting tools.

Important Notes for this Upgrade

Regulatory updates introduced in this release will require pre-migration procedures to be completed prior to data migration. Please read and carefully follow these instructions to ensure successful data migration and product upgrade.

Prepare to Upgrade

Please follow these instructions to ensure that your supporting tools are compatible with Liquent InSight 6.2 CHF 5.

| Step | Action | Resource |
|------|-------------------------------------------------------------------------------------------------------------------------------------------------------------------------------------------------------------------------------------------------------------------------------------------------------------------------|--------------------------------------------------------------------------------------------------------------------------------------------------------------------------------------------------------------------------------------------------------------------------------------------------------------------------------------------------------------------------------------------------------------------------------------------|
| 1 | Before starting the upgrade procedures, please review the Liquent InSight 6.2 System Support Documentation (SSD) to ensure that all system hardware and software components are compatible with the upgrade. | System Support Documentation |
| | For general information about this release, see the Liquent InSight 6.2 CHF 5 Release Notes. | Liquent InSight 6.2 CHF 5 Release Notes |
| 2 | Determine the applicable migration path to Liquent InSight 6.2 CHF 5 depending on your current installation. | Migration Path |
| 3 | Complete all the preceding installation procedures according to your migration path to upgrade your system to Liquent InSight 6.2 CHF 4, using appropriate upgrade packages. Refer to the documentation for every release for specific instructions, ensure corresponding pre and post- migration steps, if applicable. | Previous release documentation: <ul style="list-style-type: none"> • Liquent InSight 6.2 Installation Guide • Liquent InSight 6.2 CHF 1 Installation Guide • Liquent InSight 6.2 CHF 2 Installation Guide • Liquent InSight 6.2 CHF 3 Installation Guide • Liquent InSight 6.2 CHF 4 Upgrade Guidelines |
| 4 | If you use Liquent SmartLink for PDF, ensure that you are using Liquent SmartLink for PDF v1.8 CHF 1 with Liquent SmartLink for PDF CHF 1 Hotfix 1.8.1.2 installed. | You must apply Liquent SmartLink for PDF CHF 1 Hotfix 1.8.1.2 to a system running Liquent SmartLink for PDF v1.8 CHF 1. These are available for download at the FTP site. |
| 5 | Only the latest version of Liquent InSight Rendering is supported. | You must apply Liquent InSight Rendering 4.4 CHF 2. |

Data Migration

| Step | Action | Resource |
|------|-------------------------------------------------------------------------------------------------------------------------------------------------------------------------------------------------------------------------------------------------------------------------------------------------------------------------------------------------------------------------------------------------------------------------------------------------------------------------------------------------------------------------------------------------------------------------------------------------------------------------------------------------------------------------------------------------------------------------------------------------------------------------------------------------------------------------------------------------|--------------------------------------------------------------------------------------|
| 1 | Create a backup copy of your database. | N/A |
| 2 | Before updating your database, verify that you have read all the Liquent InSight 6.2 CHF 5 Data Migration Document information carefully and have the required level of access to Liquent InSight 6.2 CHF 4 to complete all the pre-migration tasks listed in the document. | Liquent InSight 6.2 CHF 5 Data Migration Document |
| 3 | <p>Apply Liquent InSight 6.2 CHF 5 data migration package to your database by following instructions provided in the Liquent InSight 6.2 CHF 5 Database Server Installation Qualification script.</p> <p>Notes:</p> <ul style="list-style-type: none"> • Custom database objects in ISM schema are removed during the migration. • Ensure that you are running the Oracle Database installation SQL script on a Windows based computer. If your Oracle Database is hosted by a Unix server, you must run the Oracle Database installation SQL script on a Windows client that can remotely access the database server using Oracle's SQL*Plus. • If you have not updated the database before, or if you are unsure how to apply database migration script, contact Technical Support before proceeding. | Liquent InSight 6.2 CHF 5 Database Server Installation Qualification |

Application Server

| Step | Action | Resource |
|------|--------------------------------------------------------------------------------------------------------------------------------------------------------------------------------------------------------------------------------------------------------------------------------------------------------------------------------------------------------------------------------------------------------------------------------------------------------------------------------------------------------------------------------------------------------------------------------------------------------------------------------------------------------------------------------------------------------------------------------------------------------------------------------------------------------------------------------------------------------------------------------------------------------------------------------------------------------------------------------------------------------------------------------------------------------------------------------------------------------|-----------------------------------------------------------------------------------------|
| 1 | <p>Prepare to install a Liquent InSight 6.2 CHF 5 Application Server by completing the following applicable procedures:</p> <ul style="list-style-type: none"> • Save copies of all files that are being replaced to another location, such as a shared network drive. • As a precaution, backup and save all files associated with your Liquent InSight system that you have modified, even if they are not listed in the instructions in the following topics and are not to be replaced during this upgrade. • For any customizable files included with this certified hotfix, such as properties files or template files, compare the new files to your existing files (by performing a diff procedure, for example) to determine whether changes were made that you need to carry forward to the new files. • If you have modified the standard overrides in Liquent InSight, contact Technical Support for assistance with preparing your overrides for this upgrade. XML changes will be required and some functionality may be impacted as a result. | N/A |
| 2 | Install a Liquent InSight 6.2 CHF 5 Application Server by following instructions provided in the Liquent InSight 6.2 CHF 5 Application Server Installation Qualification script. | Liquent InSight 6.2 CHF 5 Application Server Installation Qualification |

Complete the Upgrade

| Step | Action | Resource |
|------|--------------------------------------------------------------------------------------------------------------------|-----------------------------------------------------------------------------|
| 1 | Complete Client Configuration according to the Liquent InSight 6.2 CHF 5 Client Installation Qualification script. | Liquent InSight 6.2 CHF 5 Client Installation Qualification |

| Step | Action | Resource |
|------|-------------------------------------------------------------------------------------------------------------------------------------------------------------------------------------------------------------------------------------------------------------------------------------------------------------------|---------------------------------------------------------------------------------------------------------------------------------------------------------------------------------------------------------------------------------------------------------------------------------------------------------------------------------------------------------------------------------------------------------------------------------------------------------------------------------------------------------------------------------------------------------------------------------------------------------------------------------------------------------------------------------------------------------------------|
| 2 | Complete all post migration tasks listed in the Liquent InSight 6.2 CHF 5 Data Migration Document, if applicable. | Liquent InSight 6.2 CHF 5 Data Migration Document |
| 3 | Post-installation procedures <ul style="list-style-type: none"> • Complete the post-installation tasks. • Create assembly templates from template files. • Ensure the most current versions of DTD files and template files are installed with Liquent InSight 6.2 CHF 5. | <ul style="list-style-type: none"> • Post-installation Tasks • Create Assembly Templates from Template Files • DTD Files • eCTD Template Files |
| 4 | To complete the upgrade process, use these links to the optional supporting tools. This is a list of the current, optional supporting tools as of the date this topic was updated.. Other versions of these tools may be supported as well. Consult the Liquent InSight SSD for details on these versions. | <ul style="list-style-type: none"> • Liquent SmartLink for PDF 1.8 CHF 1 Installation You must apply Liquent SmartLink for PDF CHF 1 Hotfix 1.8.1.2 to a system running Liquent SmartLink for PDF v1.8 CHF 1. These are available for download at the FTP site. • Liquent InSight Rendering 4.4 CHF 2 Installation. • Liquent SmartLink for Word 1.8 CHF 1 Installation • Liquent Cumulative View Builder 2.3 Installation • Liquent InSight 6.2 CHF 5 Analytics Server Upgrade Installation Qualification • Liquent InSight Validator 5.1 Installation |

Migration Path

To use the latest version of the Ligent InSight 6.2 certified hotfix, follow the migration path that is applicable to your current version of Ligent InSight

The order in which the migration scripts should be run is indicated by the name of the individual ZIP files containing the database scripts. Please refer to the respective release notes for each database migration script.

Important points about the database migration flow:

- The upgrade to any Ligent InSight 6.2 CHF can only be done from Ligent InSight 6.2. Follow the database migration path from your current version of Ligent InSight 6.2 before proceeding to the database migration for Ligent InSight 6.2 CHF.
- The upgrade to Ligent InSight 6.2 can only be done from the Ligent InSight 6.1 CHF 4 and later CHFs. To upgrade to earlier version of Ligent InSight refer to installation procedures for Ligent InSight 6.1
- When migrating from a previous version of Ligent InSight to a newer, major version of the product, your saved Public and Private queries will not be saved. After your migration is completed, if an error appears when running a query saved in your previous version, use the selected values on the query page to create a new saved query.

The following flowcharts illustrate the database migration path for Ligent InSight 6.2, the supported Oracle database version, and required pre- and post-migration steps for each Ligent InSight 6.2 version.

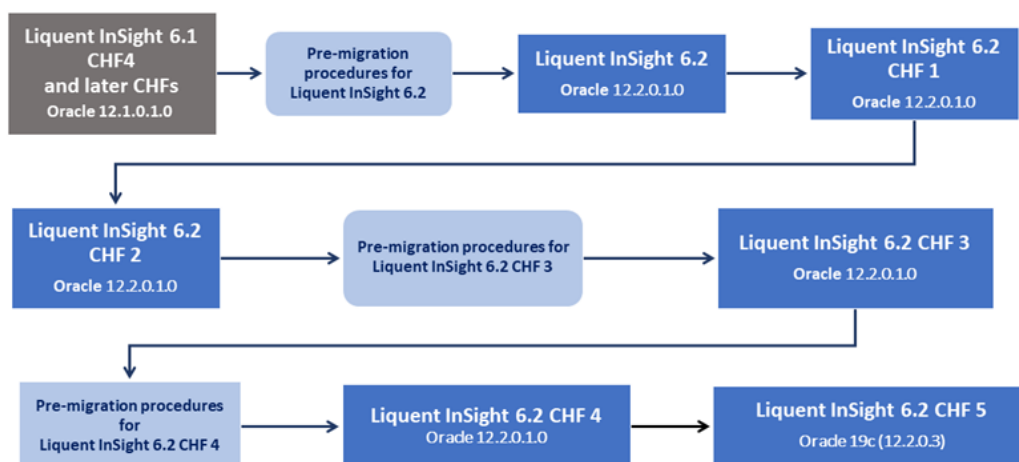

The following table lists the upgrade packages that need to be used during the migration to the most recent Ligent InSight 6.2 CHF.

| Ligent InSight Version | Upgrade Package | Application Server Build |
|--------------------------|----------------------------------|--------------------------|
| Ligent InSight 6.2 | DB_update6_2_0_0000_0200.z ip | 6.2.0.0.0296 |
| Ligent InSight 6.2 CHF 1 | DB_hotfix6_2_0_chf1_0015.z ip | 6.2.0.1.0004 |

| Liquent InSight Version | Upgrade Package | Application Server Build |
|---------------------------|------------------------------|--------------------------|
| Liquent InSight 6.2 CHF 2 | DB_hotfix6_2_0_chf2_0062.zip | 6.2.0.2.0069 |
| Liquent InSight 6.2 CHF 3 | DB_hotfix6_2_0_chf3_0039.zip | 6.2.0.3.0062 |
| Liquent InSight 6.2 CHF 4 | DB_hotfix6_2_0_chf4_0086.zip | 6.2.0.4.0079 |
| Liquent InSight 6.2 CHF 5 | DB_hotfix6_2_0_chf5_0027.zip | 6.2.0.5.0055 |

Post-Installation Tasks

Prerequisites

Before you can use any Ligent InSight 6.2 CHF, you must perform post-installation tasks.

Important: After each Certified Hotfix upgrade, Ligent InSight drops and recreates all views. This affects any custom database objects that have been created and granted rights against any of the Ligent InSight database objects. This also affects each customized report (query) which may need to be recreated. If you have any customization applied, you will need to load them back after the upgrade is completed.

After you install Ligent InSight 6.2 CHF:

1. If you customized any properties files before you installed the CHF and you need to maintain the customizations, add your customizations to the new properties files.
2. Create new assembly templates.
3. If you customized any template files before you installed Ligent InSight 6.2 CHF, and you need to maintain the customizations, add your customizations after the certified hotfix template files are installed.
4. Clear temporary Internet files in Internet Explorer.
 - a) In the Internet Explorer **Tools** menu, select **Internet Options**.
 - b) On the **Internet Options** dialog box, click **Delete**.
 - c) On the **Delete Browsing History** dialog box, select the following options and then click **Delete**:
 - Temporary Internet files and website files
 - Cookies and website data
 - History
 - Download History
 - Form data
 - Tracking Protection, ActiveX Filtering and Do Not Track

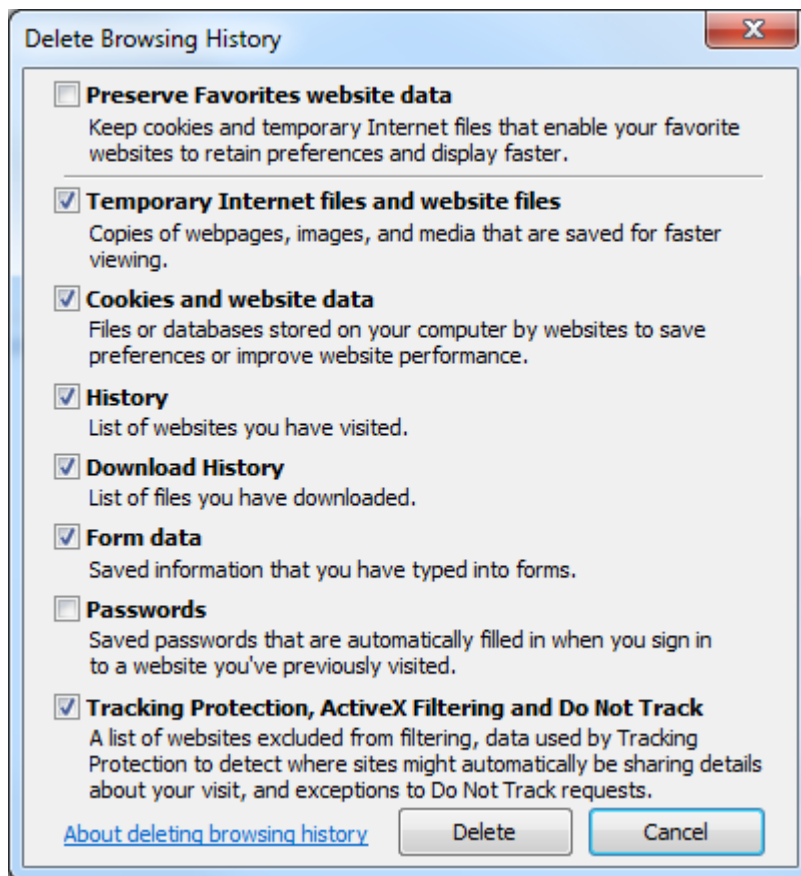

5. If you use Veeva, its temporary files accumulate on the application server and remain there until removed. To free up space on the server, delete the files from the temporary directory in the default location (C:\Users\\AppData\Local\Temp) and restart the server.

Create Assembly Templates from Template Files

Prerequisites

After you install the new Liquent InSight 6.2 CHF, create assembly templates from the template files that you import.

To create an assembly template from a template file:

1. From a Liquent InSight Web client workstation, log on to Liquent InSight.
2. If a version of the template file already exists in Liquent InSight, delete or rename the existing template file.
 - To delete the existing template - On the Liquent InSight home page, select the **Assembly Templates** tab, then choose the template. On the **More** menu, select **Delete** and then confirm the deletion.
 - To rename the existing template - On the Liquent InSight home page, select the **Assembly Templates** tab, then choose the template. Click the **Edit** icon, update the **Name** field, and click **Save**.
3. Navigate to the **Assembly Templates** tab, and then in the menu bar, click **New > Template**. The **Create Template** page appears.
4. Select **Assembly File**, browse to the location where you saved your new templates, and then choose the assembly template file.
5. Set **Use Source Assembly Publishing Settings Library** to **Yes**.
6. Set the **Import Publishing Elements** to **Yes**.
7. Click **Next**. The **Assembly Attributes** page appears for the template you created.

DTD Files

To conform to the current submission specifications, you must update the DTD files to the latest version.

To make sure that you have the current version of each listed DTD file on your system, refer to the **Last Modified Build** column in the table. This column displays the product build number in which the file was introduced or updated.

| Component | Customizable | Last Modified Build |
|----------------------------|--------------|---------------------|
| \DTDs\au-0-90.zip | No | 6.2.0.0.0296 |
| \DTDs\au-0-90-ectd.zip | No | 6.2.0.0.0296 |
| \DTDs\au-3-0.zip | No | 6.2.0.0.0296 |
| \DTDs\au-3-0-ectd.zip | No | 6.2.0.0.0296 |
| \DTDs\au-3-1.zip | No | 6.2.0.0.0296 |
| \DTDs\au-3-1-ectd.zip | No | 6.2.0.0.0296 |
| \DTDs\au-nees-2-0.zip | No | 6.2.0.0.0296 |
| \DTDs\au-nees-2-0-ectd.zip | No | 6.2.0.0.0296 |
| \DTDs\ca-1-0.zip | No | 6.2.0.0.0296 |
| \DTDs\ca-1-0-ectd.zip | No | 6.2.0.0.0296 |
| \DTDs\ca-2-2.zip | No | 6.2.0.0.0296 |
| \DTDs\ca-2-2-ectd.zip | No | 6.2.0.0.0296 |
| \DTDs\ch-1-0-1.zip | No | 6.2.0.0.0296 |
| \DTDs\ch-1-0-1-ectd.zip | No | 6.2.0.0.0296 |
| \DTDs\ch-1-1.zip | No | 6.2.0.0.0296 |
| \DTDs\ch-1-1-ectd.zip | No | 6.2.0.0.0296 |
| \DTDs\ch-1-2.zip | No | 6.2.0.0.0296 |
| \DTDs\ch-1-2-ectd.zip | No | 6.2.0.0.0296 |
| \DTDs\ch-1-3.zip | No | 6.2.0.0.0296 |
| \DTDs\ch-1-3-ectd.zip | No | 6.2.0.0.0296 |
| \DTDs\ch-1-4.zip | No | 6.2.0.2.0069 |
| \DTDs\ch-1-4-ectd.zip | No | 6.2.0.2.0069 |
| \DTDs\ch-1-5.zip | No | 6.2.0.5.0055 |
| \DTDs\ch-1-5-ectd.zip | No | 6.2.0.5.0055 |
| \DTDs\cn-1-0.zip | No | 6.2.0.4.0079 |
| \DTDs\cn-1-0-ectd.zip | No | 6.2.0.4.0079 |
| \DTDs\eaau-1-0.zip | No | 6.2.0.5.0055 |
| \DTDs\eaau-1-0-ectd.zip | No | 6.2.0.5.0055 |
| \DTDs\eu-1-0.zip | No | 6.2.0.0.0296 |

| Component | Customizable | Last Modified Build |
|----------------------------|--------------|---------------------|
| \DTDs\eu-1-0-ectd.zip | No | 6.2.0.0.0296 |
| \DTDs\eu-1-1.zip | No | 6.2.0.0.0296 |
| \DTDs\eu-1-1-ectd.zip | No | 6.2.0.0.0296 |
| \DTDs\eu-1-2-1.zip | No | 6.2.0.0.0296 |
| \DTDs\eu-1-2-1-ectd.zip | No | 6.2.0.0.0296 |
| \DTDs\eu-1-3.zip | No | 6.2.0.0.0296 |
| \DTDs\eu-1-3-ectd.zip | No | 6.2.0.0.0296 |
| \DTDs\eu-1-4.zip | No | 6.2.0.0.0296 |
| \DTDs\eu-1-4-ectd.zip | No | 6.2.0.0.0296 |
| \DTDs\eu-2-0.zip | No | 6.2.0.0.0296 |
| \DTDs\eu-2-0-ectd.zip | No | 6.2.0.0.0296 |
| \DTDs\eu-3-0.zip | No | 6.2.0.0.0296 |
| \DTDs\eu-3-0-1.zip | No | 6.2.0.4.0079 |
| \DTDs\eu-3-0-1-ectd.zip | No | 6.2.0.4.0079 |
| \DTDs\eu-3-0-ectd.zip | No | 6.2.0.0.0296 |
| \DTDs\form-1-1.zip | No | 6.2.0.0.0296 |
| \DTDs\form-1-1-ectd.zip | No | 6.2.0.0.0296 |
| \DTDs\gc-1-2.zip | No | 6.2.0.0.0296 |
| \DTDs\gc-1-2-ectd.zip | No | 6.2.0.0.0296 |
| \DTDs\gc-1-5.zip | No | 6.2.0.4.0079 |
| \DTDs\gc-1-5-ectd.zip | No | 6.2.0.4.0079 |
| \DTDs\hr-1-4.zip | No | 6.2.0.0.0296 |
| \DTDs\hr-1-4-ectd.zip | No | 6.2.0.0.0296 |
| \DTDs\ich-3-2.zip | No | 6.2.0.0.0296 |
| \DTDs\ich-3-2-ectd.zip | No | 6.2.0.0.0296 |
| \DTDs\jo-1-0.zip | No | 6.2.0.4.0079 |
| \DTDs\jo-1-0-ectd.zip | No | 6.2.0.4.0079 |
| \DTDs\jp-1-0.zip | No | 6.2.0.0.0296 |
| \DTDs\jp-1-0-ectd.zip | No | 6.2.0.0.0296 |
| \DTDs\pim-2-1.zip | No | 6.2.0.0.0296 |
| \DTDs\pim-2-1-ectd.zip | No | 6.2.0.0.0296 |
| \DTDs\schema.properties | Yes | 6.2.0.4.0079 |
| \DTDs\stf-2-2.zip | No | 6.2.0.0.0296 |
| \DTDs\stf-2-2-3-0.zip | No | 6.2.0.0.0296 |
| \DTDs\stf-2-2-3-0-ectd.zip | No | 6.2.0.0.0296 |

| Component | Customizable | Last Modified Build |
|-------------------------------|--------------|---------------------|
| \DTDs\stf-2-2-5-0.zip | No | 6.2.0.2.0069 |
| \DTDs\stf-2-2-5-0-ectd.zip | No | 6.2.0.2.0069 |
| \DTDs\stf-2-2-ectd.zip | No | 6.2.0.0.0296 |
| \DTDs\th-0-92.zip | No | 6.2.0.0.0296 |
| \DTDs\th-0-92-ectd.zip | No | 6.2.0.0.0296 |
| \DTDs\th-1-0.zip | No | 6.2.0.0.0296 |
| \DTDs\th-1-0-ectd.zip | No | 6.2.0.0.0296 |
| \DTDs\us-2-01.zip | No | 6.2.0.0.0296 |
| \DTDs\us-2-01-ectd.zip | No | 6.2.0.0.0296 |
| \DTDs\us-2-01-ectd-folder.zip | No | 6.2.0.0.0296 |
| \DTDs\us-3-3.zip | No | 6.2.0.0.0296 |
| \DTDs\us-3-3-ectd.zip | No | 6.2.0.0.0296 |
| \DTDs\za-1-0.zip | No | 6.2.0.0.0296 |
| \DTDs\za-1-0-ectd.zip | No | 6.2.0.0.0296 |
| \DTDs\za-2-1.zip | No | 6.2.0.0.0296 |
| \DTDs\za-2-1-ectd.zip | No | 6.2.0.0.0296 |

eCTD Template Files

Liquent InSight includes ICH-compliant eCTD templates with preconfigured folder types to capture the metadata for the specific headings in the eCTD that require additional information: drug substance, drug product, excipient, clinical indication, and regional administrative information.

To ensure that you have the current version of each listed template file on your system, refer to the **Modified/Introduced in Version** column in the **Template Files** table. This column contains information about the template status for every version in the Liquent InSight6.2 branch:

- **No** - template was not updated
- **Yes** - template was updated
- **New** - template introduced or updated
- **Blank** - template did not exist for the release

| Template | Modified/Introduced in Version | | | | | |
|------------------------------------------------|--------------------------------|-----------------------|-----------------------|-----------------------|-----------------------|-----------------------|
| | 6.2 | 6.2 CHF 1 | 6.2 CHF 2 | 6.2 CHF 3 | 6.2 CHF 4 | 6.2 CHF 5 |
| | Build 6.2.0.0.0296 | Build 6.2.0.1.0004 | Build 6.2.0.2.0069 | Build 6.2.0.3.0039 | Build 6.2.0.4.0079 | Build 6.2.0.5.0055 |
| templates\510k Template (Sep 2019).xml | | | | | New | No |
| \templates\510k template.xml | No | No | No | No | No | No |
| \templates\A4SampleTOCTemplate.docx | No | No | No | No | No | No |
| \templates\ASEAN ACTD-NeeS.xml | No | No | No | No | No | No |
| \templates\AU eCTD Module 1 v0.90.xml | No | No | No | No | No | No |
| \templates\AU eCTD Module 1 v3.0.xml | No | No | No | No | No | No |
| \templates\AUS Module 1 CTD v2.1.xml | No | No | No | No | No | No |
| \templates\AUS Module 1 CTD-NeeS v2.0 2011.xml | No | No | No | No | No | No |
| \templates\AU Module 1 eCTD v3.1.xml | New | No | No | No | No | No |
| \templates\AU Module 1 NeeS v2.0.xml | New | No | No | No | No | No |
| \templates\Canadian eCTD Module 1 v1.0.xml | No | No | No | No | No | No |
| \templates\Canadian eCTD Module 1 v2.2.xml | No | No | No | No | No | No |

| Template | Modified/Introduced in Version | | | | | |
|------------------------------------------------------------|--------------------------------|-----------------------|-----------------------|-----------------------|-----------------------|-----------------------|
| | 6.2 | 6.2 CHF 1 | 6.2 CHF 2 | 6.2 CHF 3 | 6.2 CHF 4 | 6.2 CHF 5 |
| | Build 6.2.0.0.0296 | Build 6.2.0.1.0004 | Build 6.2.0.2.0069 | Build 6.2.0.3.0039 | Build 6.2.0.4.0079 | Build 6.2.0.5.0055 |
| \\templates\Canadian electronic CTA CTA-A-29-May-2013.xml | No | No | No | No | No | No |
| \\templates\Canadian electronic CTA.xml | No | No | No | No | No | No |
| \\templates\CH eCTD Module 1 v1.0.1.xml | No | No | No | No | No | No |
| \\templates\CH eCTD Module 1 v1.1.xml | No | No | No | No | No | No |
| \\templates\CH eCTD Module 1 v1.2.xml | No | No | No | No | No | No |
| \\templates\CH eCTD Module 1 v1.3.xml | No | No | No | No | No | No |
| \\templates\CH eCTD Module 1 v1.4.xml | | | New | Yes | No | No |
| \\templates\CH eCTD Module 1 v1.5.xml | | | | | | New |
| \\templates\CN eCTD Module 1 v1.0.xml | | | | | New | No |
| \\templates\CN eCTD ICH Module 2-5 v3.2.xml | | | | | New | No |
| \\templates\CN Clinical Study Report (VV5-0).xml | | | | | New | No |
| \\templates\CN Nonclinical Study Report (SEND Dataset).xml | | | | | New | No |
| \\templates\CN Nonclinical Study Report.xml | | | | | New | No |
| \\templates\eCTD ICH Module 2-5 v3.2.xml | No | No | Yes | No | No | No |
| \\templates\EAEU Template v1.0.xml | | | | | New | Yes |
| \\templates\EU CTA.xml | No | No | No | No | No | No |
| \\templates\EU eCTD Module 1 v1.0 - CP.xml | No | No | No | No | No | No |
| \\templates\EU eCTD Module 1 v1.0 - MRP-DCP.xml | No | No | No | No | No | No |

| Template | Modified/Introduced in Version | | | | | |
|---------------------------------------------------|--------------------------------|-----------------------|-----------------------|-----------------------|-----------------------|-----------------------|
| | 6.2 | 6.2 CHF 1 | 6.2 CHF 2 | 6.2 CHF 3 | 6.2 CHF 4 | 6.2 CHF 5 |
| | Build 6.2.0.0.0296 | Build 6.2.0.1.0004 | Build 6.2.0.2.0069 | Build 6.2.0.3.0039 | Build 6.2.0.4.0079 | Build 6.2.0.5.0055 |
| \\templates\EU eCTD Module 1 v1.0 - NP.xml | No | No | No | No | No | No |
| \\templates\EU eCTD Module 1 v1.1 - CP.xml | No | No | No | No | No | No |
| \\templates\EU eCTD Module 1 v1.1 - MRP-DCP.xml | No | No | No | No | No | No |
| \\templates\EU eCTD Module 1 v1.1 - NP.xml | No | No | No | No | No | No |
| \\templates\EU eCTD Module 1 v1.2.1 - CP.xml | No | No | No | No | No | No |
| \\templates\EU eCTD Module 1 v1.2.1 - MRP-DCP.xml | No | No | No | No | No | No |
| \\templates\EU eCTD Module 1 v1.2.1 - NP.xml | No | No | No | No | No | No |
| \\templates\EU eCTD Module 1 v1.3 - CP.xml | No | No | No | No | No | No |
| \\templates\EU eCTD Module 1 v1.3 - MRP-DCP.xml | No | No | No | No | No | No |
| \\templates\EU eCTD Module 1 v1.3 - NP.xml | No | No | No | No | No | No |
| \\templates\EU eCTD Module 1 v1.4 - CP.xml | No | No | No | No | No | No |
| \\templates\EU eCTD Module 1 v1.4 - MRP-DCP.xml | No | No | No | No | No | No |
| \\templates\EU eCTD Module 1 v1.4 - NP.xml | No | No | No | No | No | No |
| \\templates\EU eCTD Module 1 v2.0 - CP.xml | No | No | No | No | No | No |
| \\templates\EU eCTD Module 1 v2.0 - MRP-DCP.xml | No | No | No | No | No | No |
| \\templates\EU eCTD Module 1 v2.0 - NP.xml | No | No | No | No | No | No |
| \\templates\EU eCTD Module 1 v3.0 - CP.xml | No | No | No | No | No | No |

| Template | Modified/Introduced in Version | | | | | |
|------------------------------------------------------------------|--------------------------------|-----------------------|---------------------------|---------------------------|-----------------------|-----------------------|
| | 6.2 | 6.2 CHF 1 | 6.2 CHF 2 | 6.2 CHF 3 | 6.2 CHF 4 | 6.2 CHF 5 |
| | Build 6.2.0.0.0296 | Build 6.2.0.1.0004 | Build 6.2.0.2.006 9 | Build 6.2.0.3.003 9 | Build 6.2.0.4.0079 | Build 6.2.0.5.0055 |
| \\templates\EU eCTD Module 1 v3.0 - MRP- DCP.xml | No | No | No | No | No | No |
| \\templates\EU eCTD Module 1 v3.0 - NP.xml | No | No | No | No | No | No |
| \\templates\EU eCTD Module 1 v3.0.1 - CP.xml | No | No | No | No | No | No |
| \\templates\EU eCTD Module 1 v3.0.1 - MRP- DCP.xml | No | No | No | No | No | No |
| \\templates\EU eCTD Module 1 v3.0.1 - NP.xml | No | No | No | No | No | No |
| \\templates\EU eCTD Module 1 v3.0.3 - CP.xml | New | No | No | No | No | No |
| \\templates\EU eCTD Module 1 v3.0.3 - MRP- DCP.xml | New | No | No | No | No | No |
| \\templates\EU eCTD Module 1 v3.0.3 - NP.xml | New | No | No | No | No | No |
| \\templates\EU IMPD template.xml | No | No | No | No | No | No |
| \\templates\EU PMF Submission in eCTD.xml | No | No | No | No | No | No |
| \\templates\EU VNees - Immunological.xml | No | No | No | No | No | No |
| \\templates\EU VNees - Pharmaceutical.xml | No | No | No | No | No | No |
| \\templates\EU VNees v2.2 - Immunological.xml | No | No | No | No | No | No |
| \\templates\EU VNees v2.2 - MRL Maximum Residue Limits.xml | No | No | No | No | No | No |
| \\templates\EU VNees v2.2- Pharmaceutical.xml | No | No | No | No | No | No |
| \\templates\EU VNees v2.3 - Immunological.xml | No | No | No | No | No | No |

| Template | Modified/Introduced in Version | | | | | |
|-----------------------------------------------------------|--------------------------------|-----------------------|-----------------------|-----------------------|-----------------------|-----------------------|
| | 6.2 | 6.2 CHF 1 | 6.2 CHF 2 | 6.2 CHF 3 | 6.2 CHF 4 | 6.2 CHF 5 |
| | Build 6.2.0.0.0296 | Build 6.2.0.1.0004 | Build 6.2.0.2.0069 | Build 6.2.0.3.0039 | Build 6.2.0.4.0079 | Build 6.2.0.5.0055 |
| \\templates\EU VNeS v2.3 - MRL Maximum Residue Limits.xml | No | No | No | No | No | No |
| \\templates\EU VNeS v2.3- Pharmaceutical.xml | No | No | No | No | No | No |
| \\templates\GCC eCTD Module 1 v1.2 - GCC.xml | No | No | No | No | No | No |
| \\templates\GCC eCTD Module 1 v1.2 - NP.xml | No | No | No | No | No | No |
| \\templates\GCC eCTD Module 1 v1.5 - GCC.xml | No | No | No | No | No | No |
| \\templates\GCC eCTD Module 1 v1.5 - NP.xml | No | No | No | No | No | No |
| \\templates\HR eCTD Module 1 v1.4 - NP.xml | No | No | No | No | No | No |
| \\templates\ICH E3 Clinical Study Report (VV2-2).xml | No | No | No | No | No | No |
| \\templates\ICH E3 Clinical Study Report (VV3-0).xml | No | No | No | No | No | No |
| \\templates\ICH E3 Clinical Study Report (VV5-0).xml | | | New | No | No | No |
| \\templates\JO eCTD Module 1 v1.0.xml | | | | New | No | No |
| \\templates\JP eCTD Module 1 v1.0.xml | No | No | Yes | No | No | No |
| \\templates\JP eCTD Module 2-5 v3.2.xml | No | No | No | No | No | No |
| \\templates\MD - IMDRF (HC) IVD Template.xml | | | | | New | No |
| \\templates\MD - IMDRF nIVD Template.xml | | | | | New | No |
| \\templates\Nonclinical Study Report (SEND Dataset).xml | No | No | No | No | No | No |
| \\templates\Nonclinical Study Report.xml | No | No | No | No | No | No |

| Template | Modified/Introduced in Version | | | | | |
|------------------------------------------------|--------------------------------|-----------------------|-----------------------|-----------------------|-----------------------|-----------------------|
| | 6.2 | 6.2 CHF 1 | 6.2 CHF 2 | 6.2 CHF 3 | 6.2 CHF 4 | 6.2 CHF 5 |
| | Build 6.2.0.0.0296 | Build 6.2.0.1.0004 | Build 6.2.0.2.0069 | Build 6.2.0.3.0039 | Build 6.2.0.4.0079 | Build 6.2.0.5.0055 |
| \\templates\PMA Template (Feb 2019).xml | | | | | New | No |
| \\templates\PMA Template.xml | No | No | No | No | No | No |
| \\templates\ROW CTD Module 1.xml | No | No | No | No | No | No |
| \\templates\SampleCoverPageTemplate.docx | No | No | No | No | No | No |
| \\templates\SampleOverlayTemplate.docx | No | No | No | No | No | No |
| \\templates\SampleTOCTemplate.docx | No | No | No | No | No | No |
| \\templates\Saudi Arabia CTD Module 1 v1.0.xml | No | No | No | No | No | No |
| \\templates\TH eCTD Module 1 v0.92.xml | No | No | No | No | No | No |
| \\templates\TH eCTD Module 1 v1.0.xml | No | No | No | No | No | No |
| \\templates\UCSampleCoverPageTemplate.docx | No | No | No | No | No | No |
| \\templates\UCSampleOverlayTemplate.docx | No | No | No | No | No | No |
| \\templates\UCSampleTOCTemplate.docx | No | No | No | No | No | No |
| \\templates\US eCTD Module 1 v2.01.xml | No | No | No | No | No | No |
| \\templates\US eCTD Module 1 v3.3.xml | No | No | Yes | No | No | No |
| \\templates\ZA eCTD Module 1 v1.0.xml | No | No | No | No | No | No |
| \\templates\ZA eCTD Module 1 v2.1.xml | No | No | No | No | No | No |

Sample Templates

Liquent InSight includes additional assembly templates to enable the creation of reports or other electronic submission types. The following templates are samples for the publishing finishing options for overlays, Tables of Contents (TOC), and cover pages. Unicode (UC) templates for TOC, cover pages, and overlays are available (for A4 paper size).

- A4SampleTOCTemplate.docx
- SampleCoverPageTemplate.docx
- SampleOverlayTemplate.docx
- SampleTOCTemplate.docx
- UCSampleCoverPageTemplate.docx
- UCSampleOverlayTemplate.docx
- UCSampleTOCTemplate.docx

Liquent InSight 6.2 CHF 5 IQ Scripts

PDF copies of the Liquent InSight 6.2 CHF 5 Installation Qualification (IQ) scripts are provided for guidance in performing your installation or upgrade of Liquent InSight.

These PDF copies of the Liquent InSight 6.2 CHF 5 Installation Qualification (IQ) scripts are intended for use in conjunction with the other reference information provided in the [Upgrade Installation Guidelines](#) topic.

- [Liquent InSight 6.2 CHF 5 Application Server Installation Qualification](#)
- [Liquent InSight 6.2 CHF 5 Database Server Installation Qualification](#)
- [Liquent InSight 6.2 CHF 5 Client Installation Qualification](#)
- [Liquent InSight 6.2 CHF 5 Analytics Server Upgrade Installation Qualification](#)
- [Liquent InSight 6.2 CHF 5 Analytics Server Upgrade Verification Installation Qualification](#)

Note: To obtain Installation Qualification scripts (IQ) in Word file format, please contact your Business Development Representative.

Index

I

Installation [4](#), [6](#), [8](#), [9](#), [12](#)

R

Resolved Issues [1](#)